

Master Flash® Residential Applications

Metal • Shake • Shingle • Tile Roofing



Master Flash®
Roof Pitch Calculator



10/2018

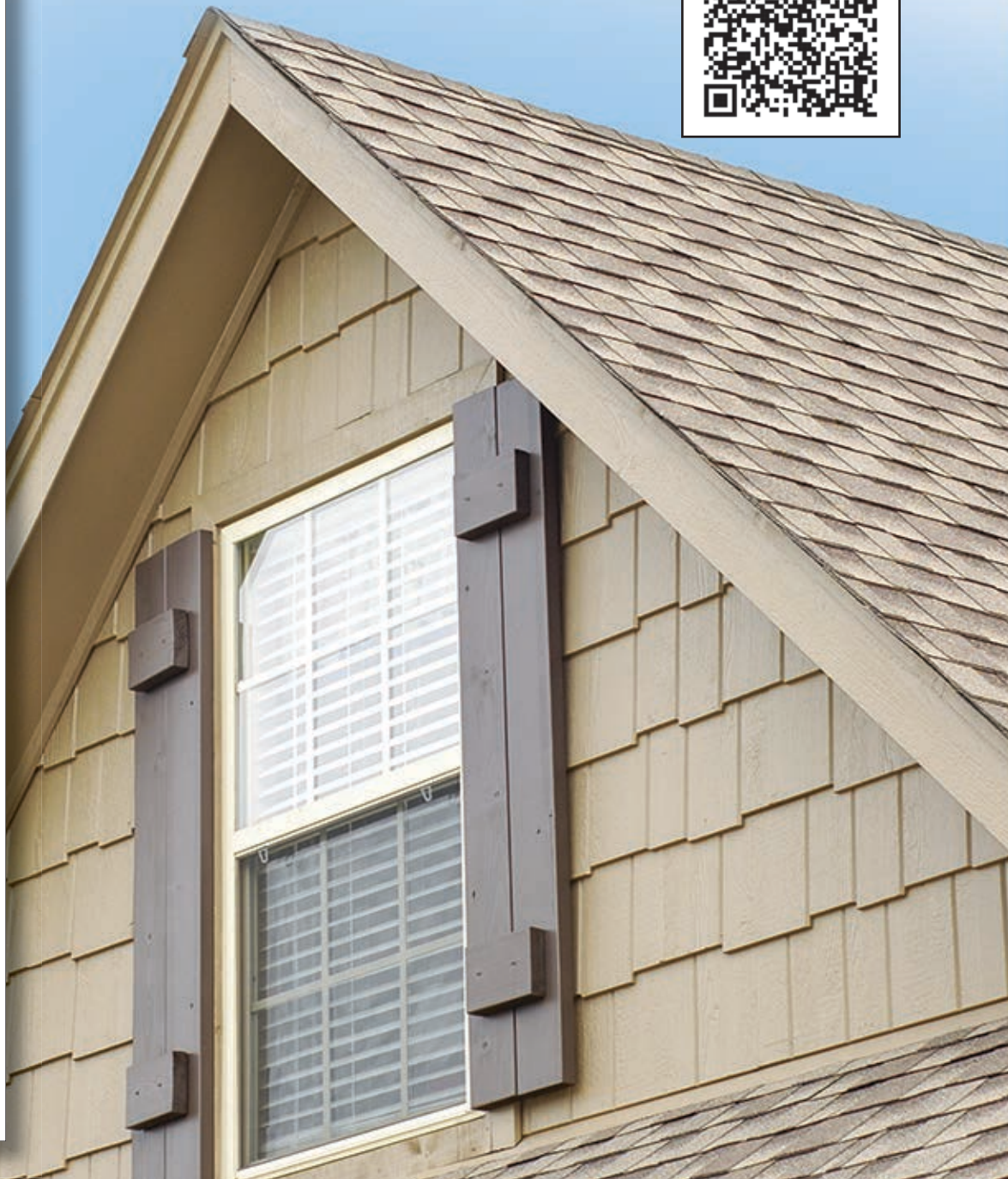

Aztec Washer Company: 13821 Danielson St., Poway, CA 92064 1-800 WASHER 5 (927-4375)
Ph: 858 513-4350 • Fax: 858 513-4305 • info@aztecwasher.com • www.aztecwasher.com

Electrical Mast Connection Master Flash®

Specifically designed for the **Residential Roofing Industry.**

Two Compounds: EPDM / High Temp Red & Grey Silicone



Advanced Ozone Resistance tested to...		EPDM 70 hour @ 500 pphm	HIGH TEMP RED OR GREY SILICONE 70 hour @ 500 pphm
High Temperature Resistance Tested to	Intermittent	+135°C (+275°F)	+260°C (+500°F)
	Continuous	+100°C (+212°F)	+225°C (+437°F)
Low Temperature Resistance tested to...		- 55°C (-67°F)	- 74°C (-101°F)
Compression Set Maximum...		25%	50%

*Complete specification data and testing methods are available upon request.

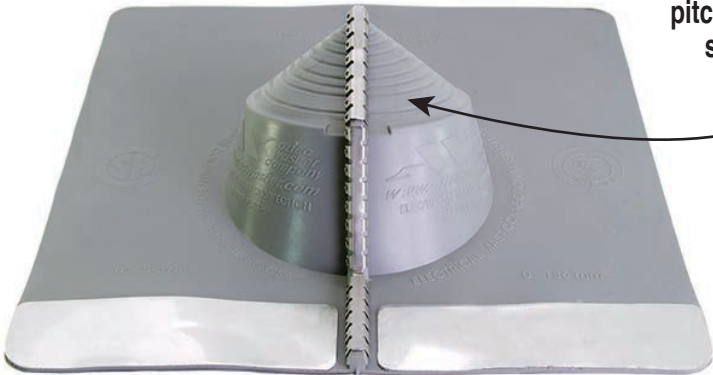

The built in 20° pitch allows adaptability to almost any pitch including 45° Stainless steel grippers included

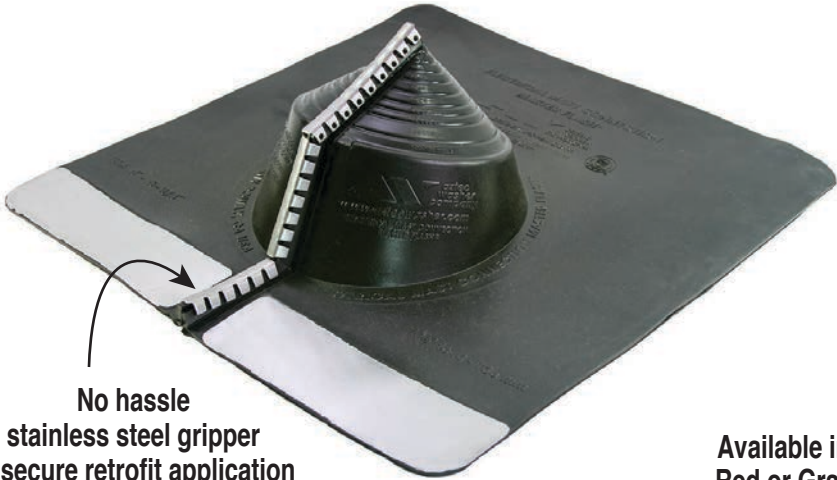

No hassle stainless steel gripper to secure retrofit application

Available in Red or Gray High Temp Silicone



Modification Made Simple
Easy to see pipe diameters make for painless on-site installation.

EMC Pipe Range: 0"-5-3/8" (0-136mm) **Top opening:** Closed • **Base:** 15" (381mm)

Solar Multi-Port - CT (Clay Tile) Master Flash®

No Fasteners Required! Just WeatherMaster™ Sealant

20
YEAR
WARRANTY



One Compound: EPDM Rubber
Black and Terra Cotta



SMP-CT Pipe Range: ONE Center port: 0" - 1-15/16" (0 - 49mm) • TWO Side ports: 3/8" (9.6mm) • TWO ports: 3/4" (20mm)
Top opening diameter: Closed • Overall height: 2-1/2" (63mm) • Base: 4-1/2" (114mm)

Solar Multi-Port-AL Master Flash®

"Environmentally safe" lead free aluminum base"

Two Compounds: EPDM / High Temp Red Silicone

20
YEAR
WARRANTY



4 Ports for cables or wires to ac
commodate copper pipes and electrical cabling



SMP-AL Pipe Range: ONE Center port: 0" - 1-15/16" (0 - 49mm) Pipe • TWO Side ports: 3/8" (9.6mm) • TWO ports: 3/4" (20mm)
Top opening diameter: Closed • Overall height: 2-1/2" (63mm) • Base: AL 17-3/4" x 24" (450 x 600mm)

Solar Multi-Port-LD Master Flash®

"Powder coated Safe-Lead metal base."

Two Compounds: EPDM / High Temp Red Silicone

20
YEAR
WARRANTY

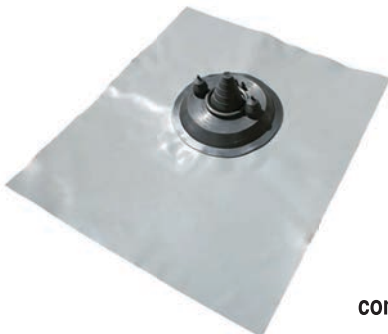

4 Ports for cables or wires to ac
commodate copper pipes and electrical cabling

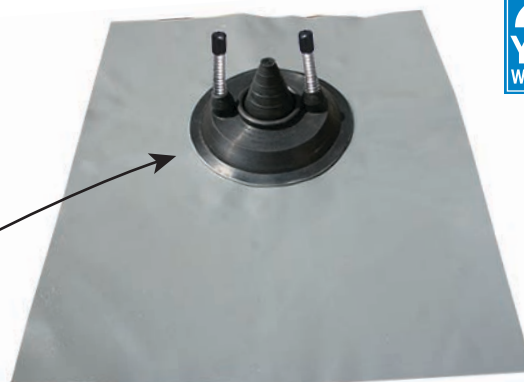

SMP-LD Pipe Range: ONE Center port: 0" - 1-15/16" (0 - 49mm) Pipe • TWO Side ports: 3/8" (9.6mm) • TWO ports: 3/4" (20mm)
Top opening diameter: Closed • Overall height: 2-1/2" (63mm) • Base: LD 16" X 19-1/4" (410 X 490mm)

RESIDENTIAL Master Flash®

“Environmentally Safe” Lead Free Aluminum Base.

A “C20” ASTM additional requirement was added to assure conformance to the most stringent ozone/weathering specifications available.

This addition allows the rubber a 20 year life.

The addition of fire retarding agents milled directly into the rubber compound creates a self extinguishing feature which enables it to be used with type “B” vents. Listed with IAPMO certification No.3121

Residential Master Flash®
Installation Video

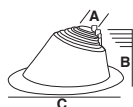

Mini Residential Flashing Details

A-Top Opening	Closed
B-Pull to suit pipe size	1/4"-3" (6-76mm)
C-Base	16"x19-1/4" (410x490mm)

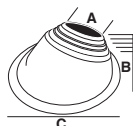

#1 Residential Flashing Details

A-Top Opening	2-1/2" (63mm)
B-Pull to suit pipe size	3"-8" (76-203mm)
C-Base	20"x24" (508x609mm)

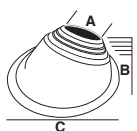

#2 Residential Flashing Details

A-Top Opening	5-5/8" (142mm)
B-Pull to suit pipe size	8"-11" (203-279mm)
C-Base	26"x30" (660x762mm)

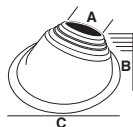

#3 Residential Flashing Details

A-Top Opening	8-3/4" (222mm)
B-Pull to suit pipe size	11"-18" (279-457mm)
C-Base	35"x 35" (889x889mm)

The built in 20° pitch allows adaptability to almost any roof pitch including 45°

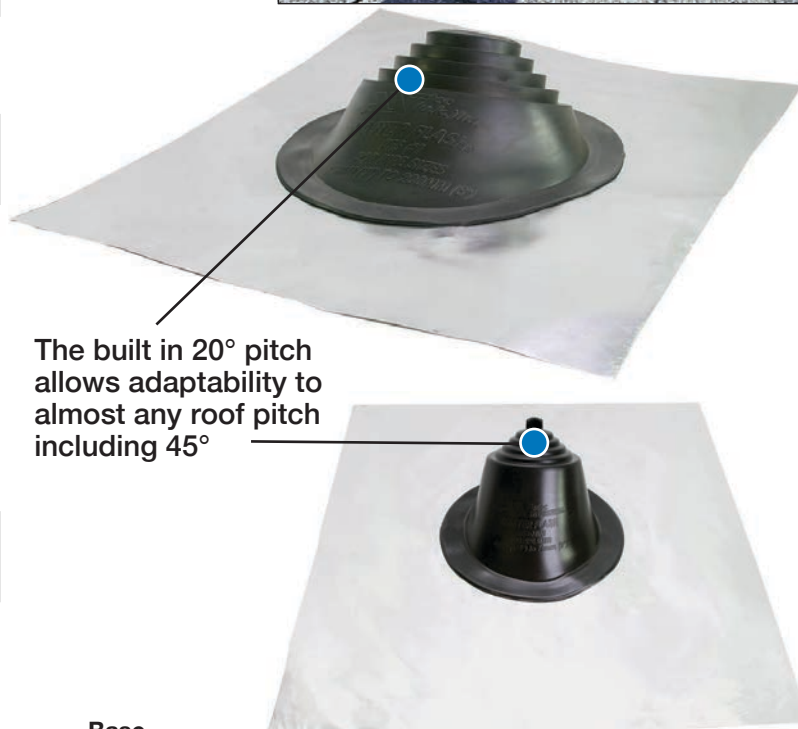

Name	Part #	Compound	Pipe Range	Base
Mini	RS051BA	Black EPDM	1/4" - 3" (6 - 76mm)	16"X19-1/4" (410X490mm)
	RS051GA	Gray EPDM		
	RS052RA	Red Silicone		
	RS052GX	Gray Silicone		
#1	RS101BA	Black EPDM	3" - 8" (76 - 203mm)	20"X24" (508X609mm)
	RS101GA	Gray EPDM		
	RS102RA	Red Silicone		
	RS102GX	Gray Silicone		
#2	RS201BA	Black EPDM	8" - 11" (203 - 279mm)	26"X30" (660X762mm)
	RS201GA	Gray EPDM		
	RS202RA	Red Silicone		
	RS202GX	Gray Silicone		
#3	RS301BA	Black EPDM	11" - 18" (279 - 457mm)	35"X35" (889X7889mm)
	RS301GA	Gray EPDM		
	RS302RA	Red Silicone		
	RS302GX	Gray Silicone		



The pull tab design and easy smooth tear grooving is intended to eliminate razor knives and allow for a circular hole

Two Compounds: EPDM / High Temp Red & Grey Silicone

Advanced Ozone Resistance tested to...		EPDM 70 hour @ 500 pphm	HIGH TEMP RED OR GREY SILICONE 70 hour @ 500 pphm
High Temperature Resistance Tested to	Intermittent	+135°C (+275°F)	+260°C (+500°F)
	Continuous	+100°C (+212°F)	+225°C (+437°F)
Low Temperature Resistance tested to...		- 55°C (-67°F)	- 74°C (-101°F)
Compression Set Maximum...		25%	50%

20
YEAR
WARRANTY

*Complete specification data and testing methods are available upon request.



“UPC approved, why buy anything else?”

Commercial • Residential • Industrial • UPC • Buy American Act Listings

APPLICATIONS



Wood Shingles



Tar Shingles



Clay Tile

Accommodate flues & vents from 1/4" diameter through 18" diameter

A “C20” ASTM additional requirement was added to assure conformance to the most stringent ozone/weathering specifications available. This addition allows the rubber a 20 year life.

5 Easy Steps

Measure & Trim



SLIDE

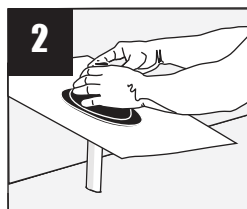

Form

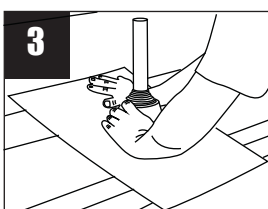

Seal

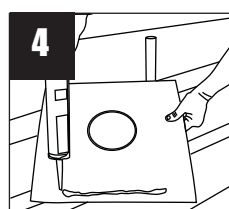

Complete

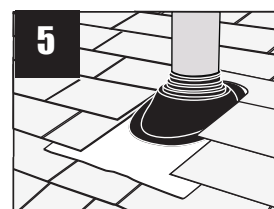

The Low-Profile Master Flash®

Specifically designed for Sidewall or Low Profile Applications



Applications:

Drywall • Sidewall Applications • Stucco Walls • Corrugated Metal Sides • Roof Penetrations



**Two Compounds: EPDM /
FDA White High Temp Silicone**

EPDM Colors Available:

Brown • Black • Dark Grey •
Light Grey • Light Grey • White
Dark Green • Light Green • Dark Blue
Light Blue • Bright Red • Terra Cotta

Low-Profile Pipe Range: 0-4" (0 - 101mm) Top opening: Closed • Overall Height: 5/16" (7.9mm) • Base: 6-1/4" (158mm)

Roof Vent Sealing Adapter Master Flash®

Specifically designed for Metal Roofing Industry

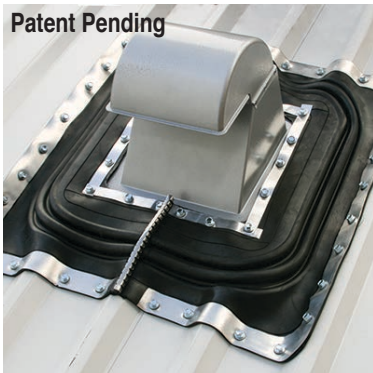

Patent Pending

Compound EPDM
Black, Light & Dark Grey

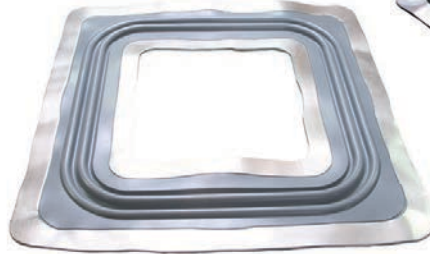

Stainless Steel Gripper & Termination Strips for
Retrofit Applications Included



Open Top Opening: 11-3/4" (298mm) X 11-3/4" (298mm) • Overall height: 1/4" (6mm) • Base: 24" (609mm)

Retrofit Opening: Closed • Standard: 0" (0mm) • Overall height: 1/4" (6mm) Base: 24" (609mm)

Master Flash® Metal Roof Sealing Tape

Sealing Joints, Seams, Holes and More!

Use on: EPDM, TPO, Hypalon, Aged PVC, Modifies, and All Metals.

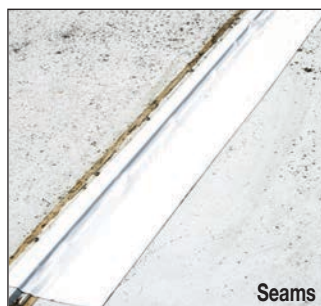

Seams



Holes



Metal Roofs

2", 4", 6", & 9 inch widths 50 foot lengths • Available in Black, Grey, White, and Tan

RES-LEAD Master Flash®

Available in Protective Coated Safe Lead Base.



Two Compounds: EPDM / High Temp Red Silicone

Advanced Ozone Resistance tested to...		EPDM 70 hour @ 500 pphm	HIGH TEMP RED OR GREY SILICONE 70 hour @ 500 pphm
High Temperature Resistance Tested to	Intermittent	+135°C (+275°F)	+260°C (+500°F)
	Continuous	+100°C (+212°F)	+225°C (+437°F)
Low Temperature Resistance tested to...		- 55°C (-67°F)	- 74°C (-101°F)
Compression Set Maximum...		25%	50%

*Complete specification data and testing methods are available upon request.

Weather Protection

Made of EPDM or Red Silicone, these flashings are compounded specifically for maximum resistance to weathering due to ozone and ultraviolet light.

A "C20" ASTM

additional requirement was added to assure conformance to the most stringent ozone/weathering specifications available. This addition allows the rubber a 20 year life.

Self extinguishing feature enables use with type "B" vents



Clay Tiles



The built in 20° pitch allows adaptability to almost any roof pitch including 45°

"ENVIRONMENTALLY SAFE"
Protective coated Safe-Lead metal base.

Mini Pipe Range: 1/4" - 3" (6 - 76mm)

Top opening diameter: Closed • Pull to suit pipe size: 1/4" - 3" (6-76mm) • Base: 16"X19-1/4" (410X490mm)

#1 Pipe Range: 3" - 8" (76 - 203mm)

Top opening diameter: 2-1/2" (63mm) • Pull to suit pipe size: 3" - 8" (76- 203mm) • Base: 20"X24" (410X490mm)

#2 Pipe Range: 8" - 11" (203 - 279mm)

Top opening diameter: 5-5/8" (142mm) • Pull to suit pipe size: 8" - 11" (203- 279mm) • Base: 26"X30" (660X762mm)

#3 Pipe Range: 11" - 18" (279 - 457mm)

Top opening diameter: Closed • Pull to suit pipe size: 11" - 18" (279 - 457mm) • Base: 35"X35" (889X889mm)

Res-Lead Master Flash® Rubber & Base Colors...

EPDM rubber is available in Black and High Temp Red Silicone

*Custom colors are available upon request. White ,Grey, Black Light and Dark Green, Light and Dark Blue, Terra Cotta (red clay appearance) and Bright Red, an additional cost may apply. Base coloring options are available an additional cost may apply.

Aztec Washer Company

Quality and Service *Worldwide*

Since 1968



INTERNATIONAL HEADQUARTERS

13821 Danielson Street, Poway, CA 92064

1-800-WASHER 5 (927-4375) • Ph: 1-858-513-4350 • F: 1-858-513-4305 • E: sales@aztecwasher.com

www.aztecwasher.com



AZTEC (UK) LTD.

Unit 55, Enterprise Trading Estate Hurst Lane, Pedmore Brierley Hill,
West Midlands DY5 1TX, United Kingdom

Tel: +44 1384 573444 • Fax: +44 1384 572029 • e-mail: sales@aztec-midlands.co.uk

www.aztec-midlands.co.uk



AZTEC INTERNATIONAL S.A.,

ul. Bulgarska 63/65, Poznan, 60-320 Poland

Tel: +48 61 867 60 84 • Fax: +48 61 867 34 44 • e-mail: sales@aztec-international.eu

www.aztec-international.eu • www.master-flash.eu



AZTEC MEXICO

Serv.y Maqs.Intls.SAdeCV.

Ph:+52 665 6542571 • Fax: +52 665 6550796 e-mail: soto@smimx.net

www.aztecwasher.mx



AZTEC AUSTRALASIA

15 Mickle Street Dandenong South Victoria, 3175

Tel: +03 9768 2394 • Fax: +03 9768 2580 • e-mail: info@aztecau.com.au

www.aztecau.com.au

To see our complete product line go to: www.aztecwasher.com



Installation Video: <http://www.aztecwasher.com/installationvideos>



Master Flash®, Universal Master Flash®, Multi-Flash Master Flash®, and Master Seal® are trademarks of Aztec Washer Company, Inc.
For Technical Support Call: 1-800-WASHER 5 (927-4375) (Outside California Only), California Callers: (858) 513-4350